

ROYAL LePAGE NORTHSHORE

2407 Marine Drive
West Vancouver, BC V7V 1L3
tel: 604.319.9964
www.markmonahan.com



#161-1100 E 29TH STREET, NORTH VANCOUVER

TOTALS*
Main Floor: 687 sq.ft.

OTHER AREAS:
Patio: 339 sq.ft.

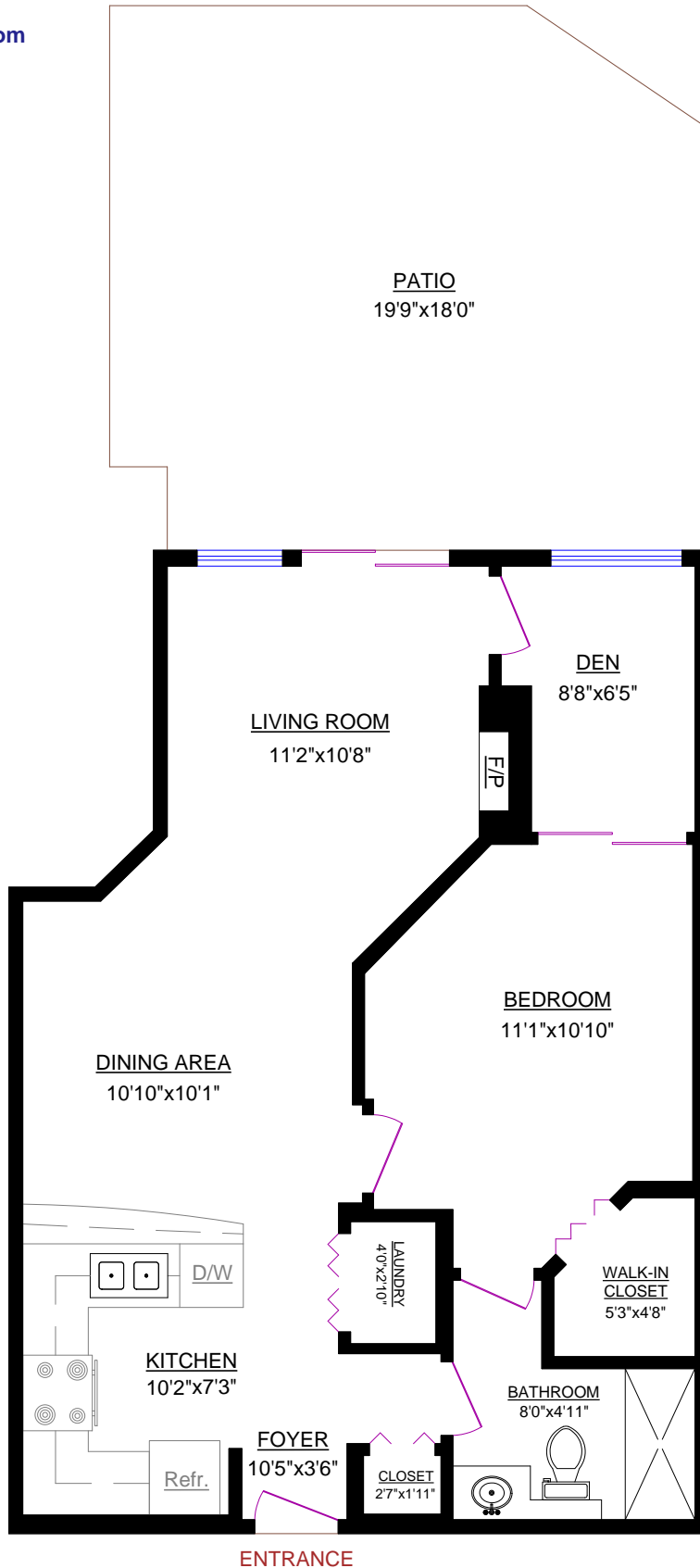

ENTRANCE

* Measured to exterior of walls and to the middle of the common walls
* These measurements are not taken from the Strata Plan.

